

Soils Map

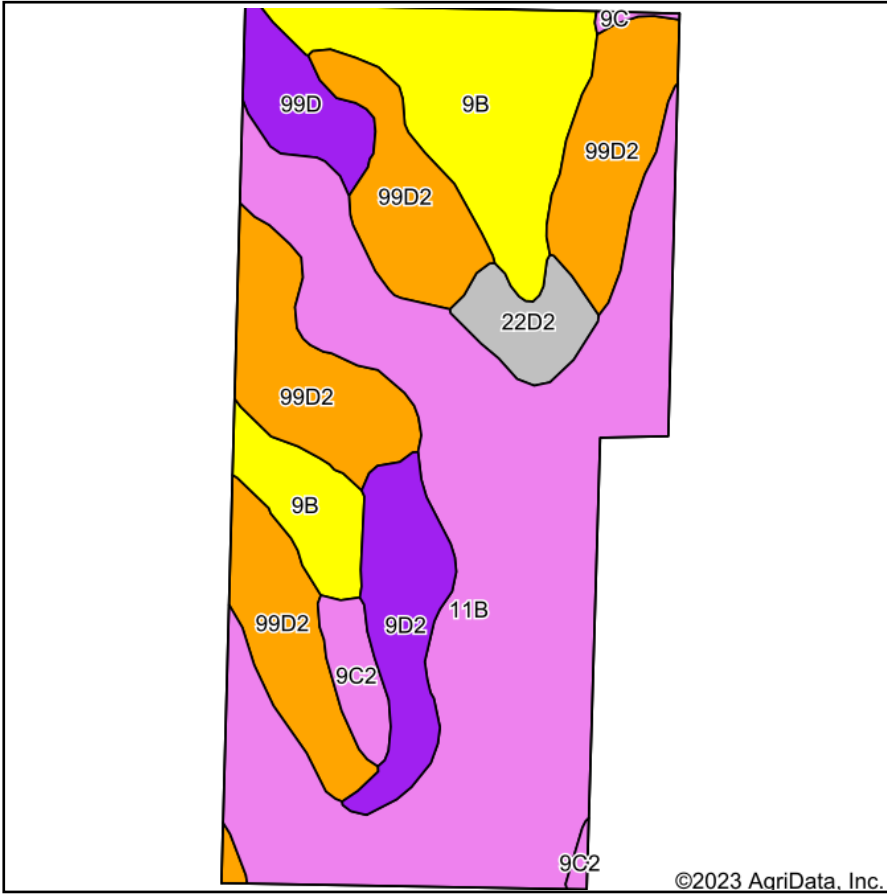

Soils data provided by USDA and NRCS.

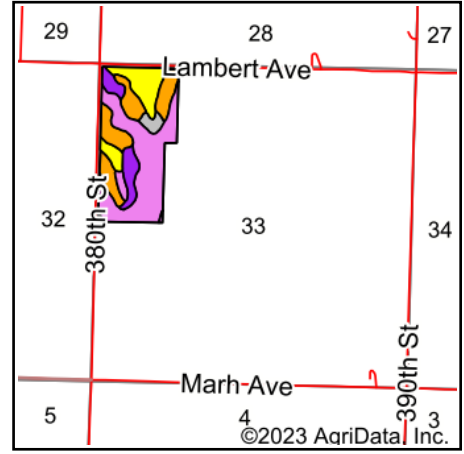

State: **Iowa**
 County: **Mills**
 Location: **33-72N-40W**
 Township: **Indian Creek**
 Acres: **69.69**
 Date: **8/9/2023**



Maps Provided By:



Area Symbol: IA129, Soil Area Version: 33

Code	Soil Description	Acres	Percent of field	CSR2 Legend	Non-Irr Class *c	CSR2**	CSR	*n NCCPI Soybeans	
11B	Colo-Judson silty clay loams, 0 to 5 percent slopes, occasionally flooded	30.32	43.5%			IIw	80	70	81
99D2	Exira silty clay loam, 9 to 14 percent slopes, eroded	17.44	25.0%			IIIe	59	53	64
9B	Marshall silty clay loam, 2 to 5 percent slopes	11.20	16.1%			Ile	95	83	76
9D2	Marshall silty clay loam, 9 to 14 percent slopes, eroded	4.31	6.2%			IIIe	61	56	64
99D	Exira silty clay loam, 9 to 14 percent slopes	2.50	3.6%			IIIe	62	60	74
22D2	Dow silt loam, 9 to 14 percent slopes, moderately eroded	2.17	3.1%			IIIe	33	40	67
9C2	Marshall silty clay loam, 5 to 9 percent slopes, eroded	1.61	2.3%			IIIe	87	66	69
9C	Marshall silty clay loam, 5 to 9 percent slopes	0.14	0.2%			IIIe	89	68	79
Weighted Average						2.40	74.1	65.6	*n 73.9

**IA has updated the CSR values for each county to CSR2.

*n: The aggregation method is "Weighted Average using all components"

*c: Using Capabilities Class Dominant Condition Aggregation Method

Soils data provided by USDA and NRCS.